

VESSEL : **ARGOSY VI**  
OFFICIAL NO. : 1054147  
OWNER : Indiana Gaming Company, L.P.  
: 775 Argosy Parkway  
Lawrenceburg, IN 47025  
LENGTH (registered) : 394.7'  
BREADTH : 88'  
DEPTH : 15'  
GROSS TONS : 1597; regulatory: 14,679 IMO  
NET TONS : 1200; regulatory: 5,027 IMO  
PROPULSION : Triple Z drive by diesel electric; 3,000 HP total  
FUEL CAPACITY : 62,000 gallons  
BUILT : 1997, Service Marine Industries / Hull # 180

---

## **DESCRIPTION**

The M/V ARGOSY VI is a four (4) passenger deck self-propelled casino vessel of all welded steel construction. The vessel has a flat bottom, with some shape and blunt entry forward, with long sloping rake aft. The sides are flat and parallel, with flat transom log. The plumb bow and curving forepeak structure meet the box hull at frame 26.

The main deck is flat, and continuous. Above the main deck are found three (3) fully enclosed passenger spaces, each being partial walk around. These are identified as the main deck, second deck, and the third deck.

The sides and bottom are ½" steel plate.

Approximately two-thirds of the way aft, both sides, the structure comes full to the side shell, where painted logos emulate a paddlewheel enclosure.

There are no external windows, and there are railings, full perimeter.

The fourth deck is a fully open deck, bow to stern, surrounded by perimeter railings. The pilothouse is set forward on the centerline, with long elevated bridge wings, port and starboard sides. Short false stacks are fitted ahead midships, with a signal mast between, set on a tabernacle.

The hull below the main deck is divided into thirteen (13) individual watertight compartments by twelve (12) transverse bulkheads.

These comprise the following:

1. Forepeak ballast
2. Port and starboard forward ballast tanks
3. Bow thruster void
4. Void space
5. Ship's offices
6. Crew lounge
7. Casino counting rooms / offices / security / galley
8. Void
9. Chiller void
10. Generator engine room
11. Propulsion engine room
12. Aft ballast void
13. Lazarette

## **EXTERNAL CONDITIONS FOUND**

External conditions are considered very good, with paint coatings near 100% and no indication of deterioration or running rust.

## 10. GENERATOR ROOM

The generator room is accessed by ladderwell to starboard, or by watertight door from the engine room, centerline aft.

This space contains the three (3) 1,400 KW generator units as follows:

<u># 4 Engine</u>	: port generator	Detroit Diesel, model 16V 149T, S/N 16E1299
	: generator	Energy Dynamics model M4RSL4673, S/N A-302011-0293, 14KW 277/480 Volt unit, operating at 1800 RPM; DOM: 1996
	: 17,222 hours	
<u># 5 Engine</u>	: center generator	Detroit Diesel model 16V-149T-6193-741, S/N 16E13001
	: generator	Energy Dynamics model 44RSL4673, S/N A-502013-0296 and its 1,400 KW at 1800 RPM; DOM: 1996
	: 16,970 hours	
<u>#6 Engine</u>	: starboard generator	Detroit Diesel Model 16V-149T-9163-7416, S/N 16E-13002
	: generator	Energy Dynamics, S/N: A-502015-0296; 14KW, 277/480 Volts at 1800 RPM, model 744RSL4673, DOM: 1996
	: 15,150 hours	

To port is found the oily bilge water tank of 3,450 gallons, followed by the port fuel tank of 25,372 gallons, and the port fuel oil day tank of 5,649 gallons.

Also found to the port side of the generator room is the 480V main switchboard panel. To the starboard side is found the starboard fuel oil tank of 25,372 gallons, with the dirty oil tank just inboard, of 1,773 gallons.

Aft, integral with the skin, is the starboard fuel oil day tank of 5,649 gallons.

Found on the aft bulkhead, to port, is the primary fire pump.

## 11. ENGINE ROOM

The engine room contains the three (3) propulsion motor generator sets, of 1,400 KW each, as follows:

# 1                    Detroit Diesel 16V-149T      9163-7416  
                         S/N: 16E-13011, 2,367 hours

Gen: 744FSS4672  
S/N: A-502039-0396  
1,400 KW, 600V @1,800 RPMs

# 2                    Detroit Diesel 16V-149T      9163-7416  
                         S/N: 16E-13022, 2,522 hours

Gen: 744FSS4672  
S/N: A-502040-0396  
1,400 KW, 600V @1,800 RPMs

# 3                    Detroit Diesel 16V-149T      9163-7416  
                         S/N: 16E-13023, 2,249 hours

Gen: 744FSS4672  
S/N: A-502041-0396  
1,400 KW, 600V @1,800 RPMs

The three (3) propulsion engines develop 600V AC, which is converted to 750V DC by transformers in the starboard engineer's office.

The propulsion engine room is accessed from a ladderwell on the port side, and an emergency escape trunk is fitted at the starboard side.

The engine room space, to starboard, also contains the secondary sprinkler pump.

The engineer's office and electrical transformer equipment is found in an enclosed space to starboard.

An emergency generator is located on the 4<sup>th</sup> deck, being a Detroit Diesel model 12V 92 TA, with S/N: 12VF-11543, showing 416 operating hours. The generator end is a model 572RSL-4640, S/N: WA-502028-0396, developing 450 KW at 1800 RPMs, of 277/480V. Emergency generator batteries are charged by Sea Charger, 10 amp 24V.

**Auxiliary Machinery:**

Bilge pump:	14 pickups from engine room manifold by 4" 40 HP 230/440V pump	
Condenser pump:	50 HP	460V
Primary sprinkler pump:	40 HP	460V
Primary fire pump	75 HP	460V
Ballast discharge pump	40 HP	460V
Secondary fire pump	75 HP	460V
Sewage pumps	10 HP	230V

24V battery bank for engine electronics with C-charger 30 amp Constavolt

**12. AFT BALLAST**

This void space is divided into port and starboard ballast, with a black water tank mounted on the centerline, integral with the bottom hull, containing 42,341 gallons.

**13. LAZARETTE**

The lazarette space contains the three (3) HRP Z-drive units and their 1,000 HP DC electric motors, and hydraulic steering controllers.

**PILOTHOUSE**

The pilothouse is located on the centerline forward midships, with bridge wings port and starboard sides. The pilothouse is steel frame structure with tempered safety glass set in aluminum frames. There are five (5) forward facing windows, center three (3) with Hepworth wipers.

The following electronics equipment is found aboard:

- (2) Furuno 1931 Mark II radar
- (1) Furuno GPS plotter Model GP-1800
- (1) Rivertronics RAI
- (2) Standard Horizon Infinity VHF radios





# Argosy VI Emergency Plan

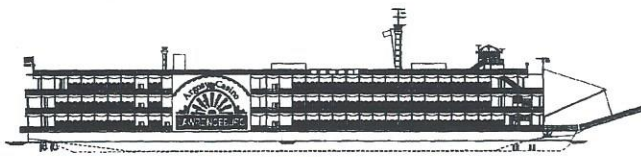
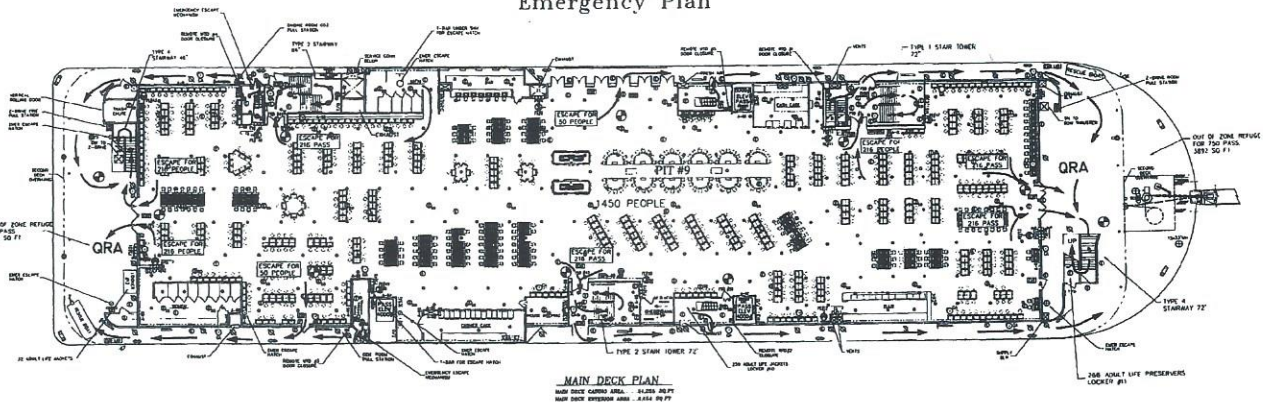

## Legend

4-60	FIRE RESISTANT BULKHEAD CLASSIFICATION	FSO	FIRE SAFE DOOR	FD	FIRE DAMPER (HARD / MANUAL)	CS	CREW STATIONS TO DIRECT PASSENGERS TO EXITS / FLOORS
BC 10	FIRE EXTINGUISHER B-I-A, C-I-A	FA	FOG SPRAY APPROPRIATOR	ES	FIRE 300V ELECTRO-MAGNETIC RELEASE - LOCAL CONTROL	CS	IONIZATION SMOKE DETECTOR
BC 15	FIRE EXTINGUISHER C-I-A, B-I-A	EL	EMERGENCY LIGHT	ES	30" RING BUSH, ORANGE	CS	SOUND POWER PHONE
BC 100	FIRE EXTINGUISHER B-I-A	BL	BLUE ROTATING BEACON - SOUND POWER PHONE	ES	30" RING BUSH, ORANGE WITH SMOKE	CS	REMOTE CO2 RELEASE
BC 110	FIRE EXTINGUISHER B-I-A	RD	RED ROTATING BEACON - GENERAL ALARM	ES	30" RING BUSH, ORANGE WITH WATERPROOF	CS	CO2 RELEASE SHOWN
BC 120	MANUAL FIRE PUSH STATION	YL	YELLOW ROTATING BEACON - MONITORING SYSTEM	ES	30" RING BUSH, ORANGE WITH 15 FIBERS OF LINE	CS	FIRE MAIN STATION
BC 130	EMERGENCY ESCAPE MECHANISM	GA	GENERAL ALARM BELL	ES	FIRE AGE	CS	EXHAUSTION LADDER
BC 140	SPRINKLER HEAD	GA	HEAT RISE INDICATOR	ES	BLUNDER	CS	RATE OF RISE DETECTOR
		GA		ES	FUEL / LUBE OIL SHUTOFF VALVE	CS	1-BAR FOR ESCAPE MECHANISM

**Argosy**  
GALVESTON COMPANY

210 PAMSA STREET, ALTON ILLINOIS 62002

**Argosy VI  
Emergency Plan  
Main Deck**

Drawn By: B.H. Date: 07/07/97 Revision: H (08/02/97)

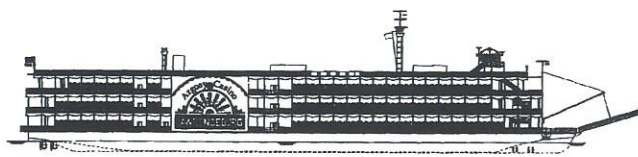
STARBOARD OUTBOARD PROFILE[illegible]

**Argosy.**  
GAMING COMPANY

219 PIASA STREET, ALTON ILLINOIS 62002

Argosy VI  
Emergency Plan  
Second Deck

Drden Bv. B.H.      Date: 07/07/97      Revision: H (08/02/99)



# Argosy VI Emergency Plan

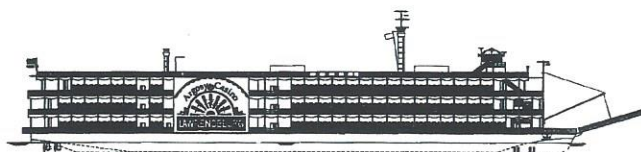
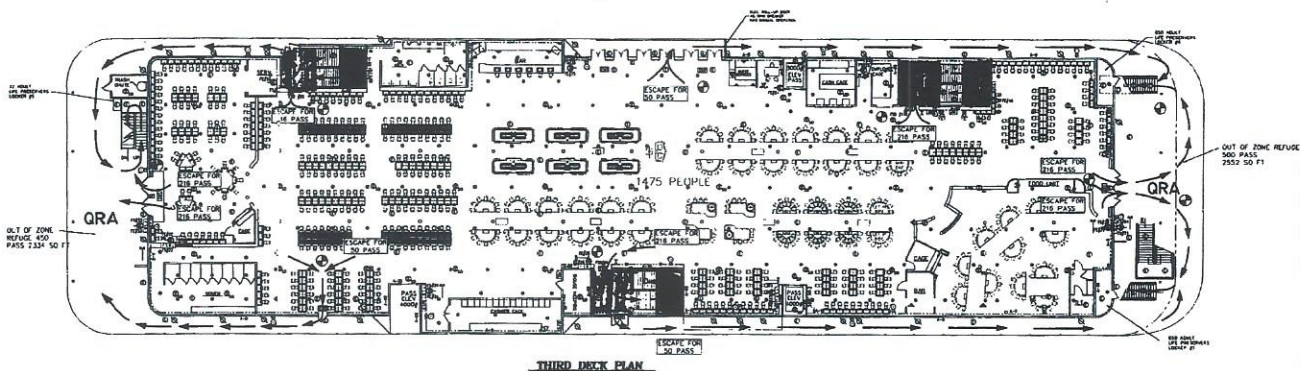

## Legend

A-60	FIRE RESISTANT BULKHEAD CLASSIFICATION	TA	FIRE TAP 700P	X	FIRE DAMPER (FAN / WINDOW)	⊙	CREW STATIONS TO DIRECT PASSENGERS TO CROSS FLOW
DC-11	FIRE EXTINGUISHER B-4, C-4	TA	FOS SPRAY APPLICATION	X	FIRE BREAK (ELECTRO-MAGNETIC RELEASE - LOCAL CONTROL)	⊙	IONIZATION SMOKE DETECTOR
DC-15	FIRE EXTINGUISHER C-4, B-4	⊙	EMERGENCY LIGHT	—	30" RING BUZZ, ORANGE	⊙	SOUND POWER PHONE
DC-100	FIRE EXTINGUISHER D-4	⊙	BLUE ROTATING BEACON - SOUND POWER PHONE	—	30" RING BUZZ, ORANGE WITH SMOKE	⊙	HEAVY DUTY RELEASE
⊙	MANUAL FIRE PULL STATION	⊙	RED ROTATING BEACON - GENERAL ALARM	—	30" RING BUZZ, ORANGE WITH WATERMOUNT	⊙	CO2 RELEASE SIREN
⊙	EMERGENCY ESCAPE MECHANISM	⊙	YELLOW F-4 LINE BEACON - MONITORING SYSTEM	—	30" RING BUZZ, ORANGE WITH 15 FATHOMS OF LINE	⊙	FIRE MAIN STATION
⊙	SPINELLER HEAD	⊙	GENERAL - AIR BELL	—	FIRE ALE	⊙	EMERGENCY LADDER
		⊙	HEAT RISE INDICATOR	—	BLUENET	⊙	RATE OF RISE DETECTOR
		⊙		—	FULL / LOSE OIL SHUTOFF VALVE	⊙	1-BAY FOR ESCAPE MECHANISM

**Argosy**  
GAMING COMPANY  
219 PARK STREET 1, ALTON BLANDS 67002  
Argosy VI  
Emergency Plan  
Third Deck

Drawn By: B-H Date: 07/07/97 Revision: H (08/02/99)

