

Memorandum

THE BERLIN

A CLASSIC CRUISE SHIP



THE BERLIN.

A SMALL CLASSIC CRUISE SHIP.

- Special routes and small harbours thanks to its size
- Favoured because of its individual services and the compassionate atmosphere



THE BERLIN.

A ROUND TOUR ON BOARD.

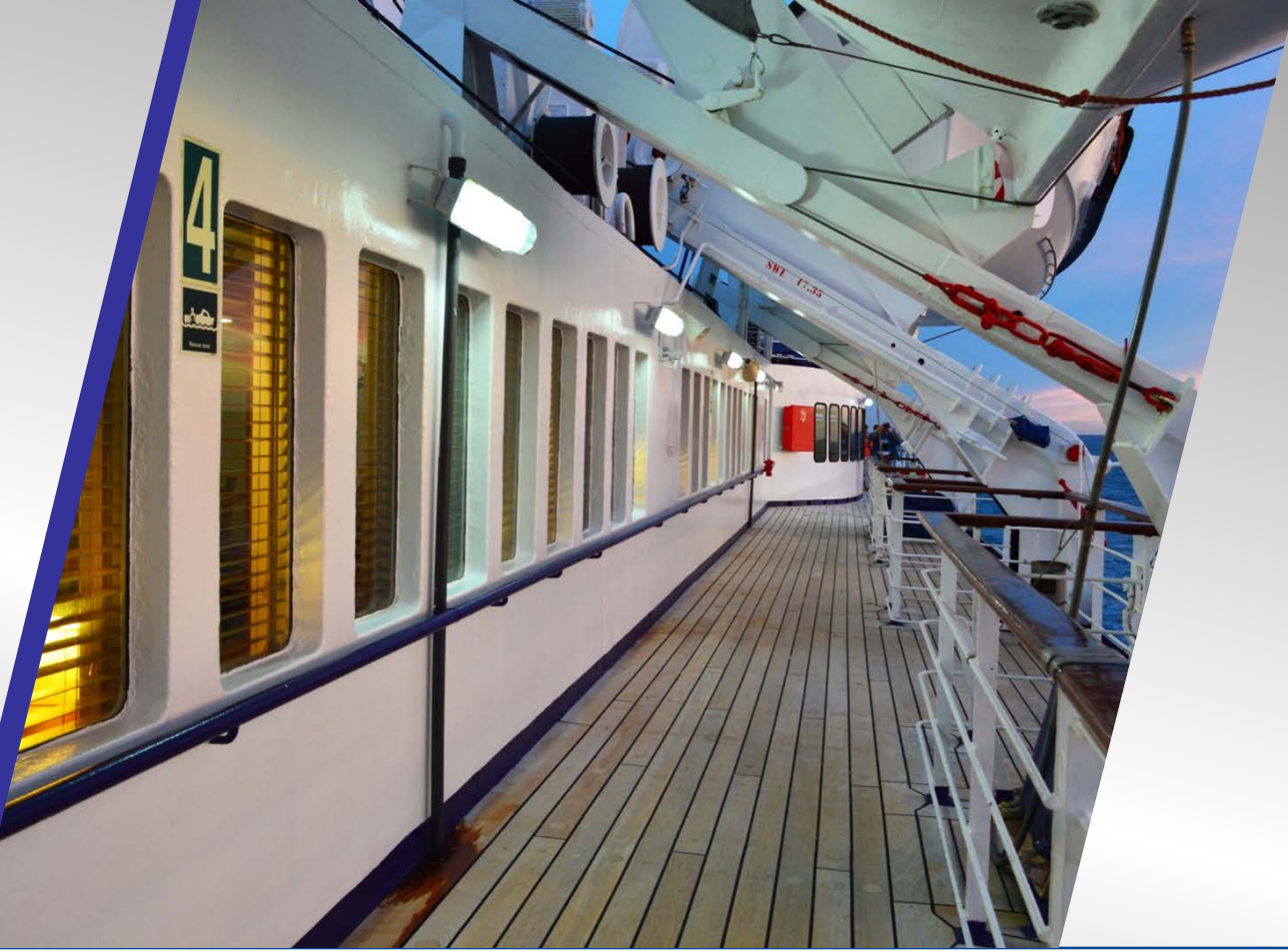

THE BERLIN.

OVERVIEW FACTS AND FIGURES.

- Flag: Malta
- Year of construction: 1980
- FTI Cruises since 2012
- Length: 139,3 m
- Width: 17,5 m
- Draught: 4,98 m
- Pax Cabins: 206
- Crew: 180



PUBLIC AREAS & PAX CABIN PLAN

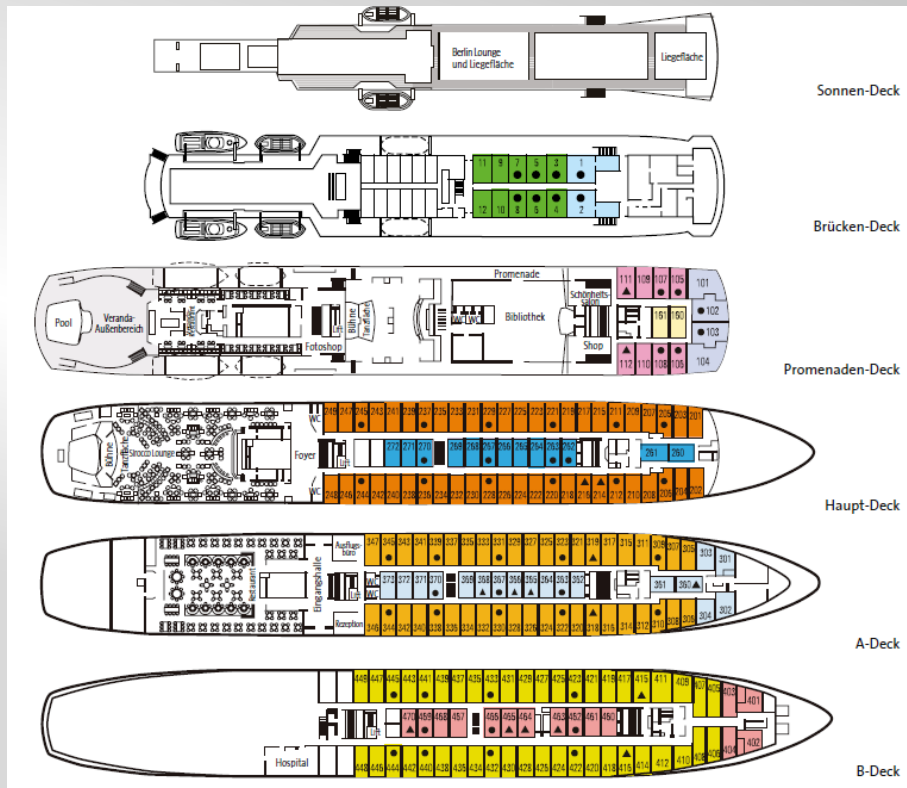

Key:

- French beds
- ▲ 2 single lower beds, 3rd upper bed rest
- rest 2 single beds

Bed Measures:

- Lower beds → 85 x 200 cm
- French beds → 150 x 200 cm

A-DECK – RECEPTION DESK & EXCURSION OFFICE.



A-DECK – FULL SERVICE MAIN RESTAURANT.



MAIN DECK – SHOWTIME & ENTERTAINMENT AT SIROCCO LOUNGE.



PROMENADE DECK – YACHT CLUB CLASSIC PIANO BAR.



PROMENADE DECK – LIBRARY.



PROMENADE DECK – BUFFET BAR RESTAURANT VERANDAH & POOL.



SUN DECK – BERLIN ROOF TOP LOUNGE & BAR.



PROMENADE DECK – OUTSIDE POSSIBILITIES.



PROMENADE DECK – BOUTIQUE & SHOP.



PROMENADE DECK – BEAUTY & COIFFEUR.



PROMENADE DECK – POINT OF SALE PHOTO SHOP.



D-DECK – FITNESS & SPA AREA WITH SAUNA.



BRIDGE DECK – BRIDGE & PREMIUM ROOF TOP CABINS.



HOSPITAL.



THE BERLIN.

CABINS – YOUR HOME PORT ON BOARD.



OVERVIEW CATEGORIES & CABIN MEASUREMENTS

KAT.	Deck	Description		Measurements	No. of Cabins
► Interior cabins					
KA	B-Deck	Standard Interior	2 lower or french beds, 3rd bed, shower/toilet	13,2 m²	15
KB	A-Deck	Comfort Interior	2 lower or french beds, 3rd bed, shower/toilet	13,2 m²	18
KC	Main Deck	Superior Interior	2 lower or french beds, shower/toilet	13,2 m²	13
KD	Promenade	Premium Interior	2 lower beds, shower/toilet	13,2 m²	2
► Outside cabins					
KE	B-Deck	Standard outside	2 lower or french beds, 3rd bed, shower/toilet with bull-eye	13,2 m²	44
KF	A-Deck	Select outside	2 lower or french beds, 3rd bed, shower/toilet with windows	13,2 m²	42
KG	Main Deck	Komfort outside	2 lower or french beds, 3rd bed, shower/toilet with windows	13,2 m²	48
KH	Promenade	Superior outside	2 lower or french beds, 3rd bed, shower/toilet with windows	13,2 m²	8
KI	Bridge Deck	Premium outside	2 lower or french beds, shower/toilet with windows	15,0 m²	10
► Suits					
KJ	Promenade	Junior Suite	2 lower beds, shower/toilet with windows	15,0 / 21,0 m²	4
KK	Bridge Deck	Grand Suite	french bed, shower/toilet with windows	37,0 m²	2

INSIDE CABINS.

- Categories: standard, comfort, superior and premium
- In total: 48 cabins
- Size: 13 m²



OUTSIDE CABINS.

- Categories: standard, select, comfort, superior and premium
- In total: 158 cabins
- Size: between 13-16 m²



SUITES.

- 4 junior suites (approx. 15-21 m²)
- 2 grand suites (approx. 37 m²)



THE BERLIN.

OUR INCLUDED SERVICES.

- Full board (up to 6 meals per day)
- Coffee, tea and tap water
- Gala dinner with captain's cocktail
- Use of the fitness and wellness area with sauna
- Outside pool with beach towels
- Lending of books, DVDs and parlour games in the library



THE BERLIN.

FACTS AND FIGURES OF FTI CRUISES.

- 14.000 guests per year
- 12 winter departures from November through March with approx. 4.800 guests
- 23 summer departures from April through October with approx. 9.200 guests



THE BERLIN.

ITINERARIES IN WINTER 2018/2019.

- **22 nights transatlantic**
Lisbon – Gran Canaria – Cape Verde Islands – Barbados – St. Lucia – Martinique – Dominica – Antigua & Barbuda – Tortola – Dominican Republic – Havanna
- **7 nights Cuba & Jamaica**
Havanna – Cayman Island – Montego Bay – Santiago de Cuba – Havanna
- **7 nights Cuba & Mexico**
Havanna – Cozumel – Costa Maya – Belize City – Havanna
- **28 nights transatlantic**
Havanna – Dominican Republic – St. Maarten – Antigua & Barbuda – Azores – Lisbon – Cádiz – Motril – Almeria – Alicante – Ibiza – Valencia – Barcelona – Nice

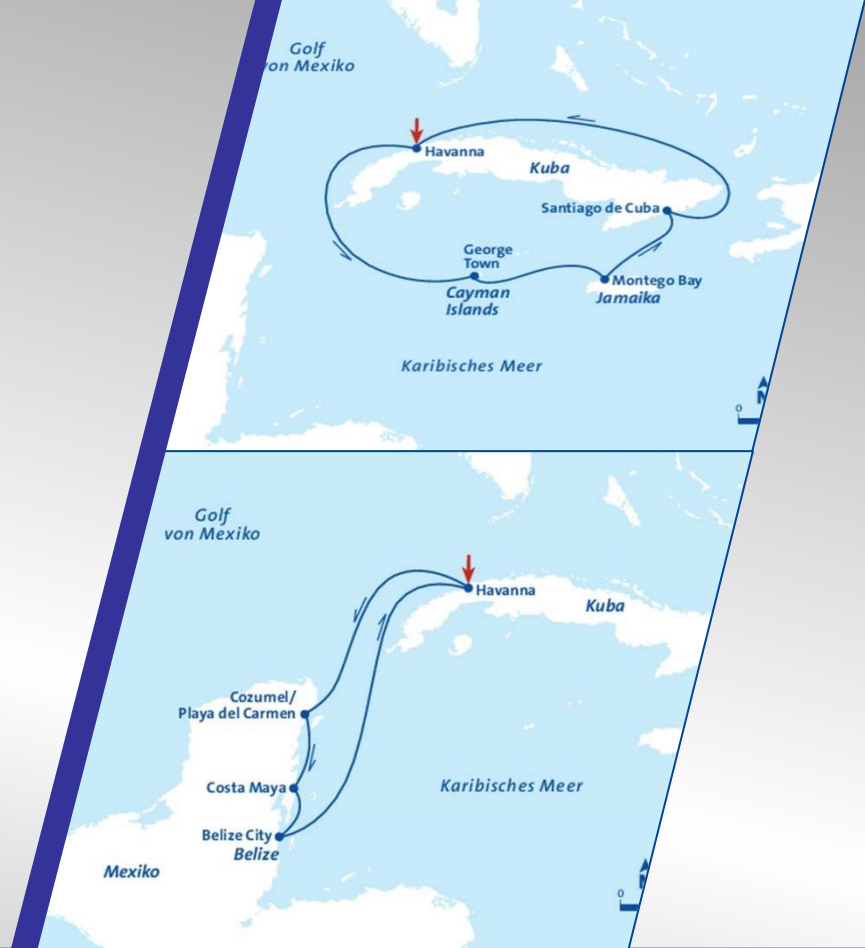

THE BERLIN.

ITINERARIES IN SUMMER 2019.

- Mediterranean Sea, around Italy, Sicily and the Liparic Islands
- Two cruises around Western Europe
- Iceland
- Norway & the North Cape, Denmark
- Greece and the Canal of Corinth
- Six event cruises: Patrick Lindner (German singer), „Schlager“ music, Fit & Active, Swing, Blues and enjoyment of wine and coffee
- Cruising to Sevilla via Guadalquivir

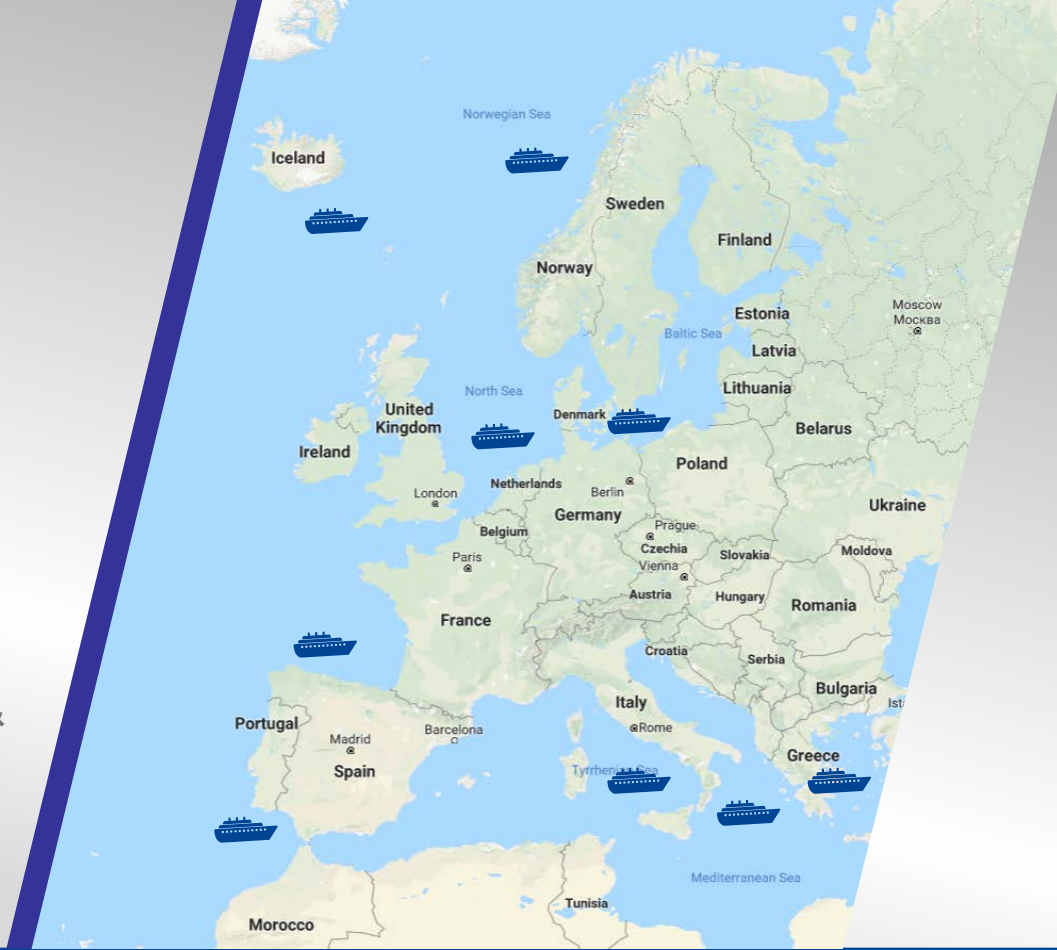

FACTS & FIGURES

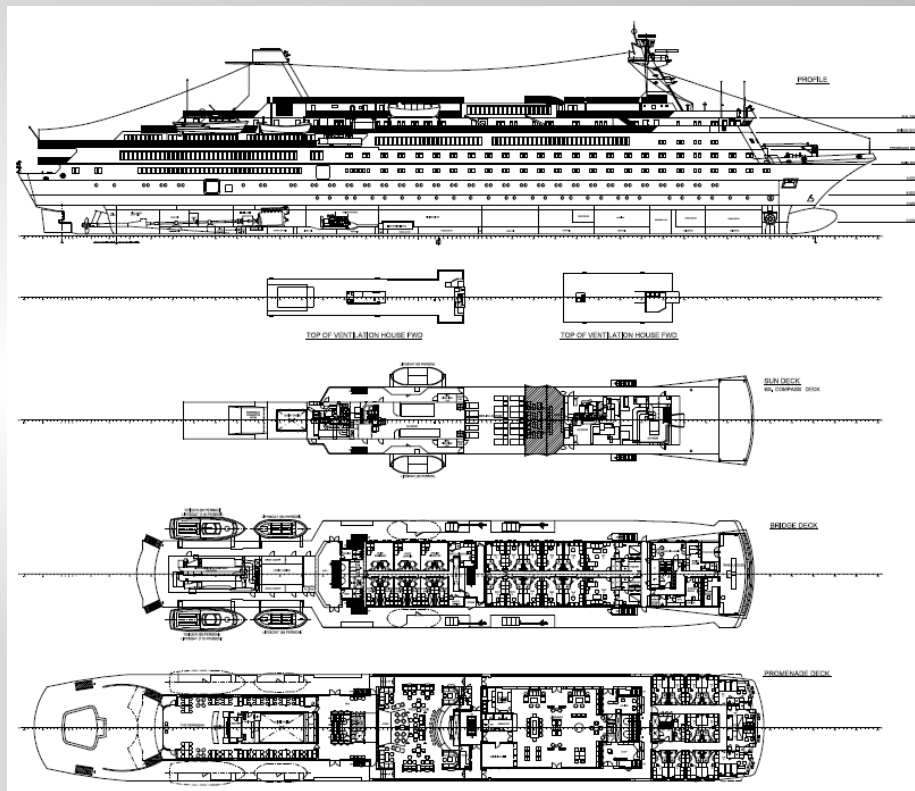

Main Particulars :

L.O.A.	: 138,30 m
L.B.P.	: 122,70 m
Breadth moulded	: 17,50 m
Depth to B-DECK	: 8,50 m
Depth to MAIN DECK	: 11,55 m
Draft	: 4,993 m
Deadweight	: 1800,00 T
Engine Output	: 7060 KW
Speed	: 16,0 KN

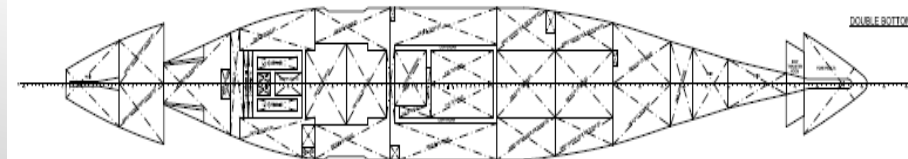
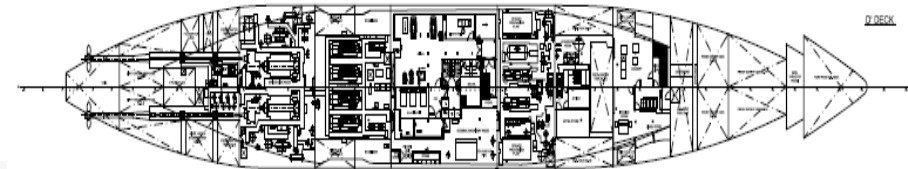
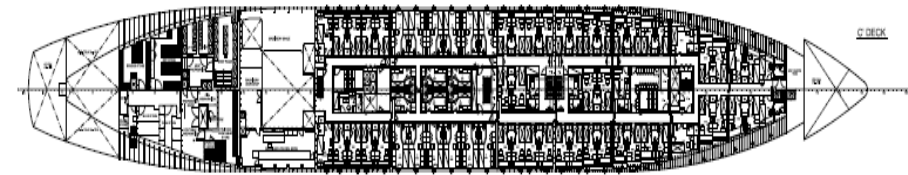
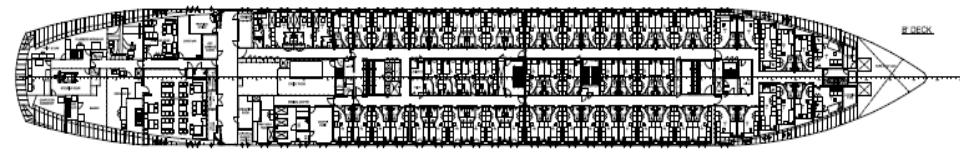
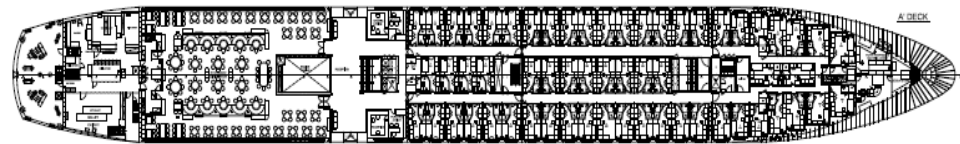
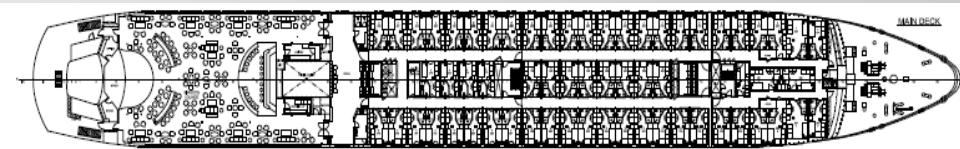

PARTICULARS

General Information

Owners	FTI Cruises Ltd. Address: Level 7, Building SCM 02/03 Smart City, Ricasoli, Kalkara SCM 1001, Malta
Bareboat Charterer	FTI Cruises GmbH, Landsberger Str. 88, 80339 Muenchen
Keel Laid	04 th September 1979
Delivery Date	1980 for P. Deilmann Reederei
Shipyard	Howaldtswerke-Deutsche Werft AG – Kiel, Yard No. 163
Hull Number	163
Flag	Malta
Class / Notation	GL 100 AS E1 Passenger ship GL + MC E1 AUT
Vessel Type	Passenger
IMO	7904889
Call Sign	9HA2295
Official No.	16250
MMSI No.	248277000
INM-C Bridge no.	424827710

Dimension

Length Over All	139.30 m
Length Btw P	122.70 m
Breadth moulded	17.50 m
Depth moulded	9.00 m
Keel to Masthead	35.20 m
Service Speed	14.5 Knots
Draft (summer)	4.98 m
Lightship	5597
Summer Displacement	7126
Tonnage	GT 9570 NT3542
Suez Tonnage	25192.45 8892.93
Panama Tonnage	NIL

LSA & FSS

Lifeboats	Six (6) Motor LB – Capa: 462 (P=234 & S=228)
Liferafts	14 L/R – Capa: 330 (10pcs x 25prns 4 4pcs x 20 prns)
WTDs	13
CO2 Fitted	Main & Aux Engine Rooms F.O., Lub oil and Separator Rooms Galley Exhaust Funnels Bosun Paint Store
Vertical Fire Zones:	5

Tank Capacities

Bunker [100% m ³]	Fuel Oil [mt]:	301.2
	Diesel Oil [mt]:	229.7
Number Storage Tanks	Fuel:	7
	MDO:	6
	Lub:	7
Grey Water [100% m ³]		295.3
Black Water [100% m ³]	Sewage treatment plant	
Lub Oil [100% m ³]		41.1
Sludge [100% m ³]		20. Jun
Bilge [100% m ³]		25. Mai
Distillate Water [100% m ³]		10. Feb
Miscellaneous [100% m ³]		
Freshwater [100% m ³]		524.9
SWBT [100% m ³]		1031
Swimming Pools: 1	Aft:	86.9 m ³

Propulsion, Aux. Machins & Tech. Information

Main Engines	2 x 3530 KW 12 Cylinder Krupp – MAK M453AK
MCR [kW]	
Propellers	2 x 5 blade, inward tuning
Aux. Engines	YANMAR 6UAL-ST:
	DG1= Ser No: 0922FUK
	DG2= Ser No: 0923FUK
	DG3= Ser No: 0924FUK
	DG4= Ser No: 0925FUK
	CATERPILLAR:
	DG5= Ser No: S2B00572
Bow Thruster	1 x 496 kW Type CAJ 400 LW6 R1
Stabilizers:	Denny-Brown
Rudders:	1 Single Center Rudder
Aux. Boilers, Economizer	

Capacities

No of Passengers	Max 412
No of Crew	Max 180
Minimum Manning	20
Decks	10
Accommodation	Pax Cabins 206 Crew Cabins 92
Hospital	Yes

Mooring Arrangements

Mooring winches

Forecastle 2 x Electric

Poop deck 2 x Electric

Mooring ropes Forecastle: 7 Poop deck: 7

Emergency towing arrangement: The largest mooring rope

Navigation & Communication

Navigation	2 x Gyro Compass ANSCHUTZ STD-22 1 x Radar SAM Electronic RADARPILOT 1000 1 x Radar DECCA Bridgemaster 1 x Radar JRC JHA-9922-6XA 1 x Magnetic Compass CASSENS & PLATH 2 x GPS, SAM EL DEBEG 4422/FURUNO GP-150 2 x ECDIS, TRANSAS Navi Planner 4000 1 x Doppler Log CONSILIUM SAL R1a 1 x Echo Sounder JRC JFE-380 1 x AIS SAAB R5 1 x VDR NETWAVE VDR NW-6000 4 x VHF Radios
Inm-C	STN ATLAS DEBEG 3220B 424827710 / -11
MF/HF Radio	1 x SAILOR 6310
VHF	SAILOR RT-2048 STN ATLAS DEBEG 6348 FURUNO FM-8900S
NAVTEX	FURUNO NX-700A

CLASSIFICATION CERTIFICATE DNV GL

Date of issue: 2018-12-11

Valid until: 2023-11-30

DNV-GL
DNV GL Id No:
G16250
Date of issue:
2018-12-11

CLASSIFICATION CERTIFICATE

Issued under the provisions of the Rules of DNV GL

Particulars of Ship

Name of Ship:	BERLIN
Builder:	Howaldtswerke-Deutsche Werft AG Hamburg und Kiel
Yard No/Hull No:	163
Owner:	FTI Cruises Ltd.
IMO Number:	7904889

This is to certify:

that the above-mentioned ship has been surveyed by DNV GL according to the Rules and that, upon completion of survey the administration of the Society is satisfied that the condition of the hull, machinery and equipment was in compliance with the applicable Rule requirements for the following class notation:

100 A5 E1 Passenger ship with cabins ERS
MC E1

Important assumptions and conditions related to maintenance and handling of the ship are found in the ship's Appendix to the Classification Certificate. Current status of surveys and conditions of class is given in the Class status issued by the Society.

This Certificate is valid until **2023-11-30** provided the requirements for the retention of class in the Rules will be complied with, and unless the class has been suspended or withdrawn.

Completion date of survey on which this Certificate is based: **2018-12-11**

Issued at **Mitrena, Portugal** on **2018-12-11**



for **DNV GL**

This document is signed electronically in accordance with DNV GL's e-Signature Policy. Validation and authentication can be obtained from trust.dnvgl.com by using the Unique Tracking Number (UTN): **01215551-000 and 30: G16250**

Manuel Peixe
Surveyor

GOOD TO KNOW

Public Space Seat Availability

Main Restaurant (Fine Dining)	48 tables & 272 seats // one Captain's table with 12 seats
Verandah Restaurant (Open Air Bar)	inside: 18 tables & 80 seats (Buffet & Grill Restaurant) outside: 40 tables & 130 seats (Buffet & Grill Restaurant)
Sirocco Lounge (Theater)	34 tables & 192 seats (with add. folding chairs, max. 292 seats)
Yacht Club (Main Classic Bar)	94 seats (with add. folding chairs, max. 124 seats)
Library	40 seats
Berlin Lounge (Sun Bar)	16 seats & four bar stools and 30 sun beds
Sun Loungers	170 sun beds on all outside decks

THE BERLIN ADVANTAGES

- Interesting routes with special harbour where other ships cannot moor/pass
- Special flair with only up to 412 passengers
- Familiar atmosphere and personel service possible
- Proximity to the crew
- High class food service and large wine offer
- Maritime ambience; public areas
- Large library - space convertible to Cognac Cigar Lounge, gaming, wellness area
- Guest wifi connection available (provider On Wave)

MS BERLIN – ABLE TO DO IT ALL.

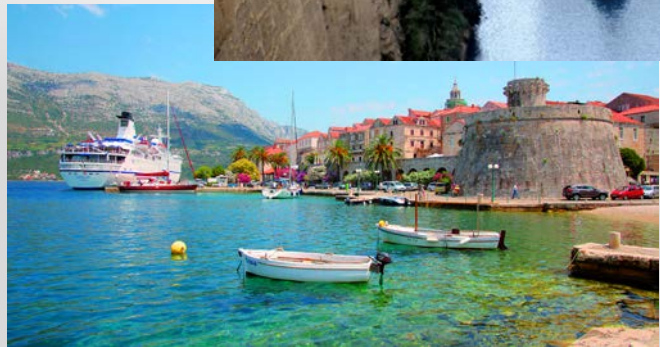

CREW CABINS.

Options: Additional to crew decks, there are ten officer cabins on bridge deck which could maybe be converted to passenger cabins for optional other use of vessel.



DISCLAIMER.

The information contained in this brochure is for general information purposes only. It is provided by FTI Cruises Limited, Republic of Malta, owner of the Vessel MS Berlin, IMO: 7904889 in good faith. We endeavor to keep the information up-to-date and correct but cannot guarantee or warrant the accuracy of this information or the condition of the vessel. In particular, we make no representations or warranties of any kind, express or implied, about the completeness, accuracy, reliability, suitability or availability with respect to the information or graphics contained in this brochure for any purpose.

Any reliance you place on such information is therefore at your own risk.

In no event will we be liable for any loss or damage including without limitation, indirect or consequential loss or damage, or any loss or damage whatsoever arising from loss of data or profits arising out of, or in connection with, the use of this brochure.

All information in this brochure is to be kept confidential. Publication and dissemination is strictly prohibited unless previously authorized by FTI Cruises Ltd.

